

Soils Map

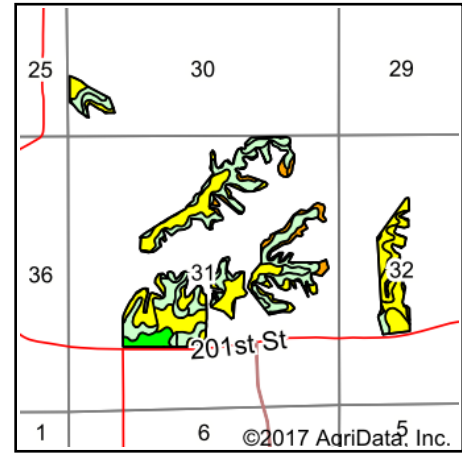

State: **Iowa**
 County: **Monroe**
 Location: **31-72N-16W**
 Township: **Mantua**
 Acres: **151.6**
 Date: **12/1/2017**

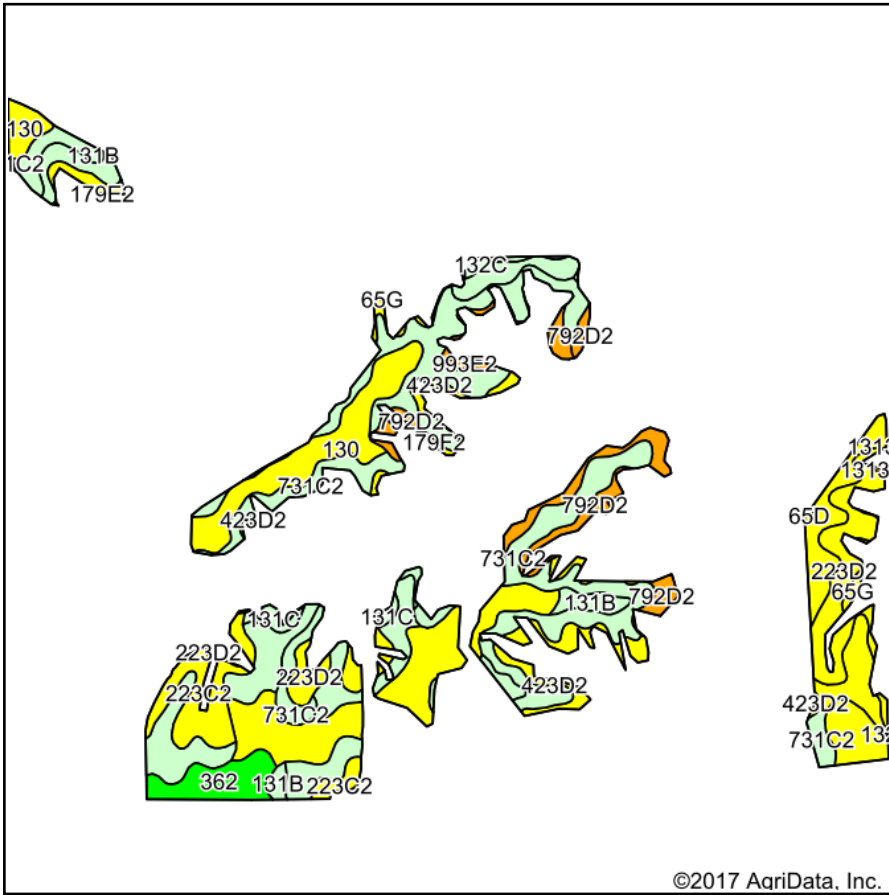

Soils data provided by USDA and NRCS.

©2017 AgriData, Inc.

© AgriData, Inc. 2017

www.AgriDataInc.com

Area Symbol: IA135, Soil Area Version: 24

Code	Soil Description	Acres	Percent of field	CSR2 Legend	Non-Irr Class *c	*i Corn	*i Soybeans	CSR2**	CS R
130	Belinda silt loam, 0 to 2 percent slopes	33.80	22.3%		IIIw	201.6	58.5	47	63
731C2	Pershing silty clay loam, 5 to 9 percent slopes, moderately eroded	27.41	18.1%		IIIe	156.8	45.5	62	45
131B	Pershing silt loam, 2 to 5 percent slopes	17.58	11.6%		IIIe	195.2	56.6	70	67
131C	Pershing silt loam, 5 to 9 percent slopes	14.89	9.8%		IIIe	177.6	51.5	65	49
223D2	Rinda silty clay loam, 9 to 14 percent slopes, moderately eroded	11.62	7.7%		IVe	97.6	28.3	19	9
732C2	Weller silty clay loam, 5 to 9 percent slopes, moderately eroded	9.36	6.2%		IIIe	169.6	49.2	59	40
223C2	Rinda silty clay loam, 5 to 9 percent slopes, moderately eroded	8.12	5.4%		IVw	126.4	36.7	45	22
792D2	Armstrong loam, 9 to 14 percent slopes, moderately eroded	7.48	4.9%		IVe	88	25.5	26	13
362	Haig silty clay loam, 0 to 2 percent slopes	5.30	3.5%		IIw	217.6	63.1	83	70
423D2	Bucknell silty clay loam, 9 to 14 percent slopes, moderately eroded	5.21	3.4%		IVe	97.6	28.3	7	13
364B	Grundy silty clay loam, 2 to 5 percent slopes	4.82	3.2%		IIe	198.4	57.5	72	75
179D2	Gara loam, 9 to 14 percent slopes, moderately eroded	1.38	0.9%		IVe	163.2	47.3	43	43
179E2	Gara loam, 14 to 18 percent slopes, moderately eroded	1.01	0.7%		VIe	139.2	40.4	35	33
993E2	Gara-Armstrong loams, 14 to 18 percent slopes, moderately eroded	0.92	0.6%		VIe	91.2	26.4	28	5
179F2	Gara loam, 18 to 24 percent slopes, moderately eroded	0.76	0.5%		VIe	115.2	33.4	12	13
132C	Weller silt loam, 5 to 9 percent slopes	0.69	0.5%		IIIe	169.6	49.2	65	44
425D2	Keswick loam, 9 to 14 percent slopes, moderately eroded	0.62	0.4%		IVe	88	25.5	9	12

65G	Lindley loam, 18 to 40 percent slopes	0.53	0.3%		Vlle	96	27.8	6	5
65D	Lindley loam, 9 to 14 percent slopes	0.10	0.1%		Ive	163.2	47.3	44	40
Weighted Average						164.8	47.8	51.7	46

**IA has updated the CSR values for each county to CSR2.

*i Yield data provided by the ISPAID Database version 8.1 developed by IA State University.

*c: Using Capabilities Class Dominant Condition Aggregation Method

Soils data provided by USDA and NRCS.