

Soils Map

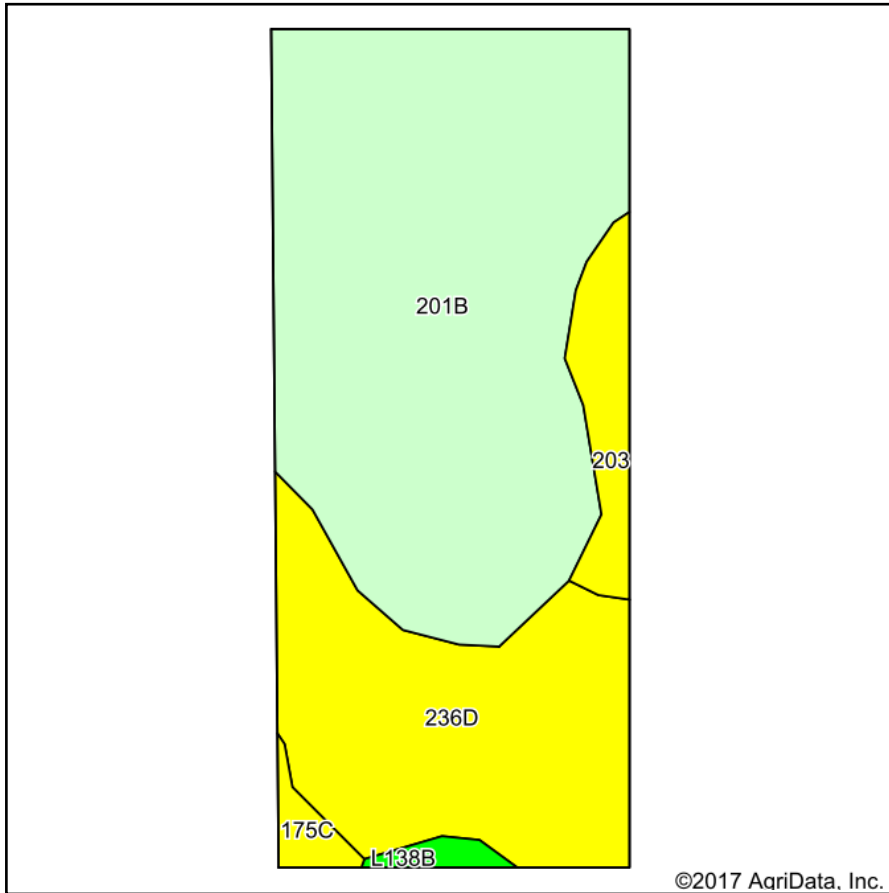

Soils data provided by USDA and NRCS.

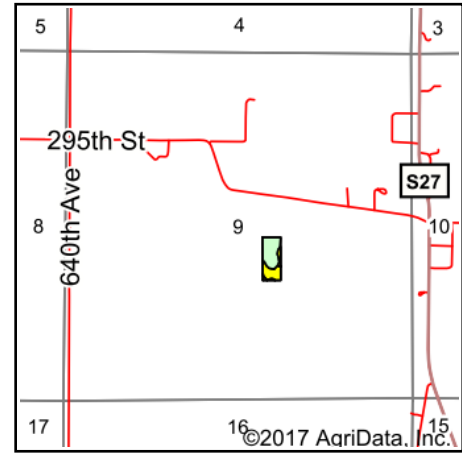

State: **Iowa**
 County: **Story**
 Location: **9-82N-22W**
 Township: **Indian Creek**
 Acres: **4.11**
 Date: **1/11/2018**



Area Symbol: IA169, Soil Area Version: 28

Code	Soil Description	Acres	Percent of field	CSR2 Legend	Non-Irr Class *c	*i Corn	*i Soybeans	CSR2**	CS R	Oat s	Spring wheat
201B	Coland-Terril complex, 1 to 5 percent slopes	2.60	63.3%		IIw	208	60.3	76	40		
236D	Lester loam, Bemis moraine, 10 to 16 percent slopes	1.21	29.4%		IVe	168	48.7	53	54	2	1
203	Cylinder loam, 0 to 2 percent slopes	0.23	5.6%		IIIs	80	23.2	58	82		
175C	Dickinson fine sandy loam, 5 to 9 percent slopes	0.07	1.7%		IIIe	80	23.2	48	42		
Weighted Average						186.9	54.2	67.7	46.5	0.6	0.3

**IA has updated the CSR values for each county to CSR2.

*i Yield data provided by the ISPAID Database version 8.1.1 developed by IA State University.

*c: Using Capabilities Class Dominant Condition Aggregation Method

Soils data provided by USDA and NRCS.