

# Soils Map

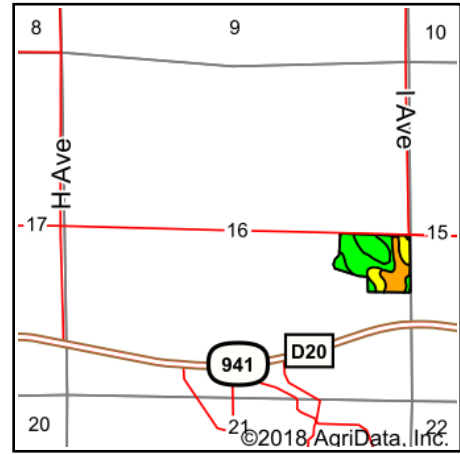

State: **Iowa**  
 County: **Hardin**  
 Location: **16-89N-21W**  
 Township: **Alden**  
 Acres: **20**  
 Date: **3/15/2018**

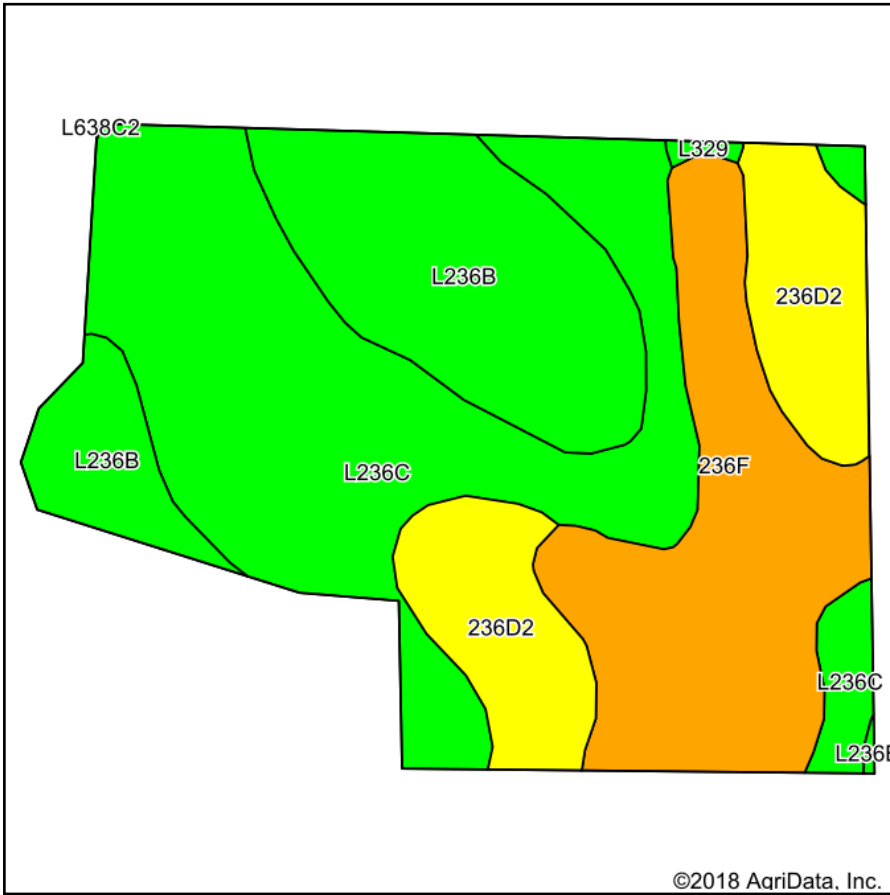

Area Symbol: IA083, Soil Area Version: 22

Code	Soil Description	Acres	Percent of field	CSR2 Legend	Non-Irr Class *c	*i Corn	*i Soybeans	CSR2**	CS R	Oat s	Spring wheat
L236C	Lester loam, Bemis moraine, 6 to 10 percent slopes	7.86	39.3%		Ille	0	0	81			
L236B	Lester loam, Bemis moraine, 2 to 6 percent slopes	4.61	23.0%		Ile	0	0	85			
236F	Lester loam, Bemis moraine, 10 to 22 percent slopes	4.43	22.2%		Vle	129.6	37.6	36	23	2	1
236D2	Lester loam, Bemis moraine, 10 to 16 percent slopes, moderately eroded	3.04	15.2%		IVe	163.2	47.3	49	51	2	1
L329	Webster-Nicollet complex, Bemis moraine, 0 to 3 percent slopes	0.06	0.3%		Ilw	0	0	89			
<b>Weighted Average</b>						<b>53.5</b>	<b>15.5</b>	<b>67.1</b>	<b>*-</b>	<b>0.7</b>	<b>0.4</b>

\*\*IA has updated the CSR values for each county to CSR2.

\*- CSR weighted average cannot be calculated on the current soils data, use prior data version for csr values.

\*i Yield data provided by the ISPAID Database version 8.1.1 developed by IA State University.

\*c: Using Capabilities Class Dominant Condition Aggregation Method

Soils data provided by USDA and NRCS.