

Soils Map

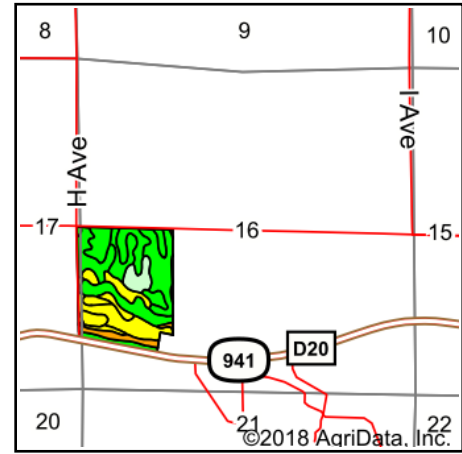

State: **Iowa**
 County: **Hardin**
 Location: **16-89N-21W**
 Township: **Alden**
 Acres: **66**
 Date: **3/15/2018**

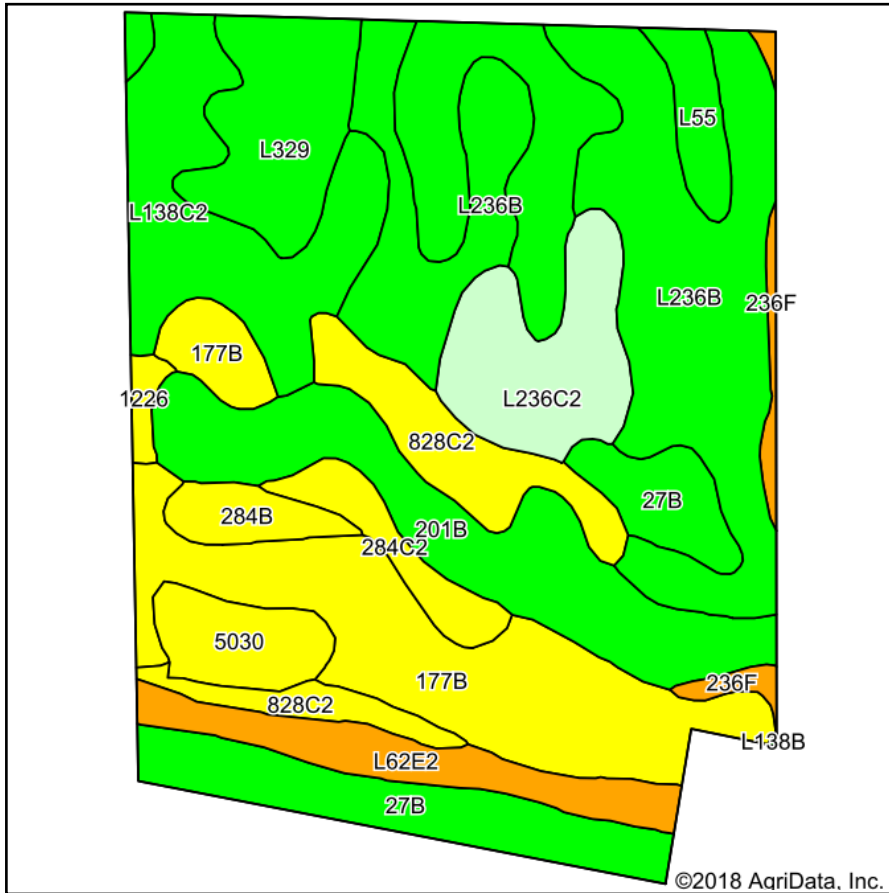

Area Symbol: IA083, Soil Area Version: 22

Code	Soil Description	Acres	Percent of field	CSR2 Legend	Non-Irr Class *c	*i Corn	*i Soybeans	CSR2**	CS R	Oat s	Spring wheat
L236B	Lester loam, Bemis moraine, 2 to 6 percent slopes	13.47	20.4%		Ile	0	0	85			
177B	Saude loam, 2 to 5 percent slopes	9.27	14.0%		Ils	80	23.2	55	58		
L329	Webster-Nicollet complex, Bemis moraine, 0 to 3 percent slopes	8.15	12.3%		Ilw	0	0	89			
201B	Coland-Terril complex, 2 to 5 percent slopes	6.81	10.3%		Ilw	208	60.3	80	69		
L138C2	Clarion loam, Bemis moraine, 6 to 10 percent slopes, moderately eroded	5.87	8.9%		Ille	0	0	83			
27B	Terril loam, 2 to 6 percent slopes	5.35	8.1%		Ile	224	65	87	84		
L236C2	Lester loam, Bemis moraine, 6 to 10 percent slopes, moderately eroded	3.93	6.0%		Ille	0	0	77		2	1
828C2	Zenor sandy loam, 5 to 9 percent slopes, moderately eroded	3.73	5.7%		Ille	80	23.2	43	34		
L62E2	Storden loam, Bemis moraine, 10 to 22 percent slopes, moderately eroded	2.81	4.3%		IVe	0	0	32			
5030	Pits, limestone quarry	1.80	2.7%			0	0	0	0		
284C2	Flagler sandy loam, 5 to 9 percent slopes, moderately eroded	1.41	2.1%		Ille	80	23.2	43	25		
L55	Nicollet loam, 1 to 3 percent slopes	1.15	1.7%		Ile	0	0	91			
284B	Flagler sandy loam, 2 to 5 percent slopes	1.10	1.7%		Ille	80	23.2	51	45		
236F	Lester loam, Bemis moraine, 10 to 22 percent slopes	0.78	1.2%		Vle	129.6	37.6	36	23	2	1
1226	Lawler loam, 0 to 2 percent slopes, rarely flooded	0.37	0.6%		Ils	80	23.2	59	73		
Weighted Average						60.4	17.5	71.2	*-	0.1	0.1

**IA has updated the CSR values for each county to CSR2.

*- CSR weighted average cannot be calculated on the current soils data, use prior data version for csr values.

*i Yield data provided by the ISPAID Database version 8.1.1 developed by IA State University.

*c: Using Capabilities Class Dominant Condition Aggregation Method