

# Soils Map

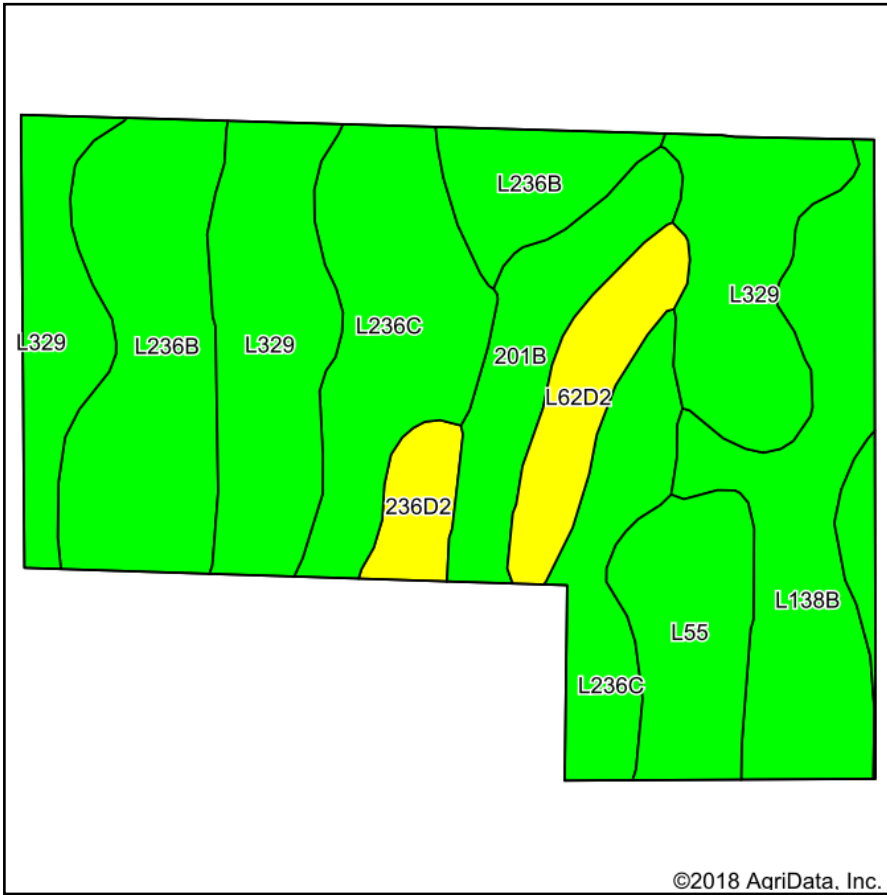

Soils data provided by USDA and NRCS.

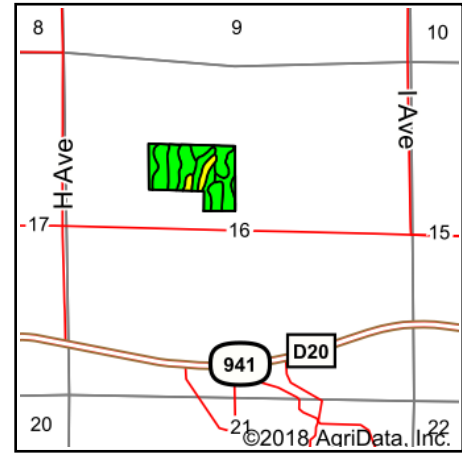

State: **Iowa**  
 County: **Hardin**  
 Location: **16-89N-21W**  
 Township: **Alden**  
 Acres: **25.33**  
 Date: **3/15/2018**



Area Symbol: IA083, Soil Area Version: 22

Code	Soil Description	Acres	Percent of field	CSR2 Legend	Non-Irr Class *c	*i Corn	*i Soybeans	CSR2**	CS R	Oat s	Spring wheat
L329	Webster-Nicollet complex, Bemis moraine, 0 to 3 percent slopes	6.82	26.9%		Ilw	0	0	89			
L236C	Lester loam, Bemis moraine, 6 to 10 percent slopes	4.71	18.6%		Ille	0	0	81			
L236B	Lester loam, Bemis moraine, 2 to 6 percent slopes	4.61	18.2%		Ile	0	0	85			
L138B	Clarion loam, Bemis moraine, 2 to 6 percent slopes	3.49	13.8%		Ile	220.8	64	88			
L55	Nicollet loam, 1 to 3 percent slopes	1.89	7.5%		le	0	0	91			
201B	Coland-Terril complex, 2 to 5 percent slopes	1.83	7.2%		Ilw	208	60.3	80	69		
L62D2	Storden loam, Bemis moraine, 10 to 16 percent slopes, moderately eroded	1.34	5.3%		IVe	0	0	41			
236D2	Lester loam, Bemis moraine, 10 to 16 percent slopes, moderately eroded	0.64	2.5%		IVe	163.2	47.3	49	51	2	1
<b>Weighted Average</b>						<b>49.6</b>	<b>14.4</b>	<b>82.6</b>	<b>*-</b>	<b>0.1</b>	<b>*-</b>

\*\*IA has updated the CSR values for each county to CSR2.

\*- CSR weighted average cannot be calculated on the current soils data, use prior data version for csr values.

\*i Yield data provided by the ISPAID Database version 8.1.1 developed by IA State University.

\*c: Using Capabilities Class Dominant Condition Aggregation Method

Soils data provided by USDA and NRCS.