

Soils Map

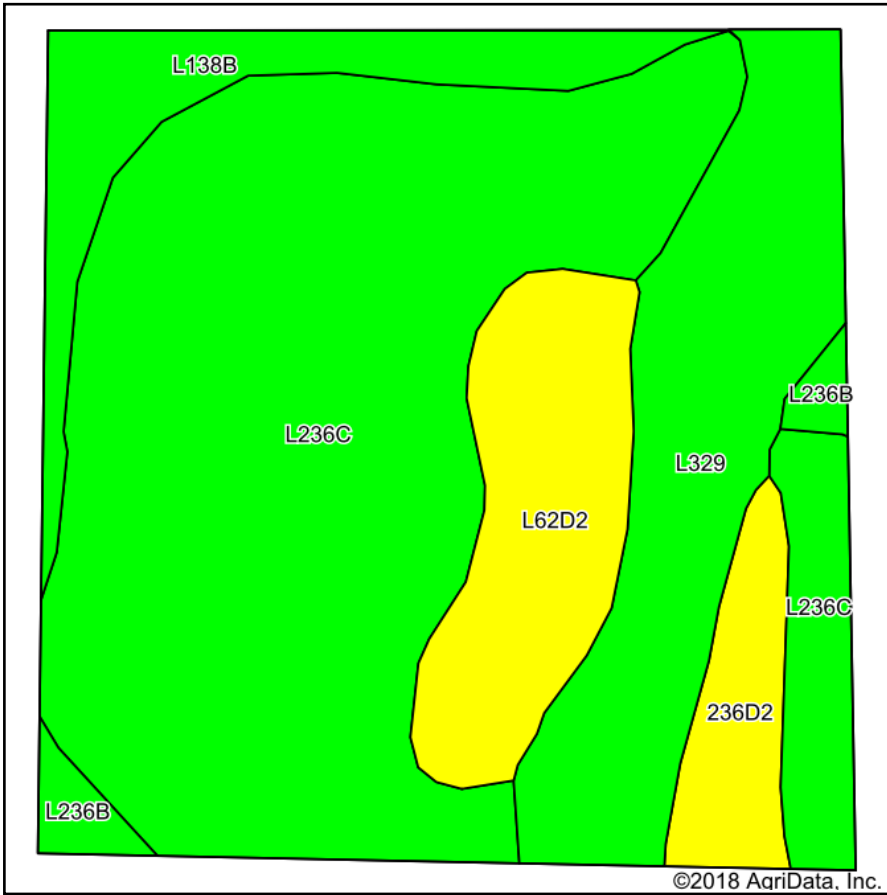

Soils data provided by USDA and NRCS.

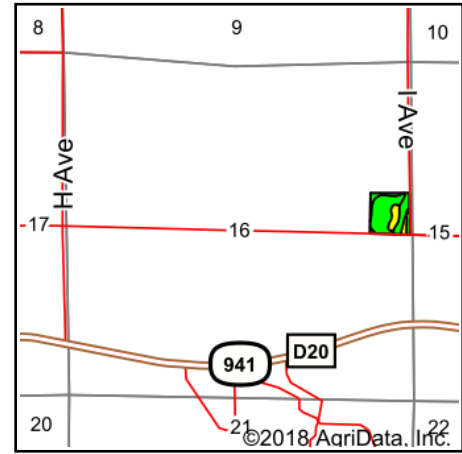

State: **Iowa**
 County: **Hardin**
 Location: **16-89N-21W**
 Township: **Alden**
 Acres: **9**
 Date: **3/15/2018**



Area Symbol: IA083, Soil Area Version: 22

Code	Soil Description	Acres	Percent of field	CSR2 Legend	Non-Irr Class *c	*i Corn	*i Soybeans	CSR2**	CS R	Oat s	Spring wheat
L236C	Lester loam, Bemis moraine, 6 to 10 percent slopes	5.07	56.3%		Ille	0	0	81			
L329	Webster-Nicollet complex, Bemis moraine, 0 to 3 percent slopes	1.61	17.9%		Ilw	0	0	89			
L62D2	Storden loam, Bemis moraine, 10 to 16 percent slopes, moderately eroded	1.01	11.2%		IVe	0	0	41			
L138B	Clarion loam, Bemis moraine, 2 to 6 percent slopes	0.74	8.2%		Ile	220.8	64	88			
236D2	Lester loam, Bemis moraine, 10 to 16 percent slopes, moderately eroded	0.41	4.6%		IVe	163.2	47.3	49	51	2	1
L236B	Lester loam, Bemis moraine, 2 to 6 percent slopes	0.16	1.8%		Ile	0	0	85			
Weighted Average						25.6	7.4	77.1	*-	0.1	*-

**IA has updated the CSR values for each county to CSR2.

*- CSR weighted average cannot be calculated on the current soils data, use prior data version for csr values.

*i Yield data provided by the ISPAID Database version 8.1.1 developed by IA State University.

*c: Using Capabilities Class Dominant Condition Aggregation Method

Soils data provided by USDA and NRCS.