

Soils Map

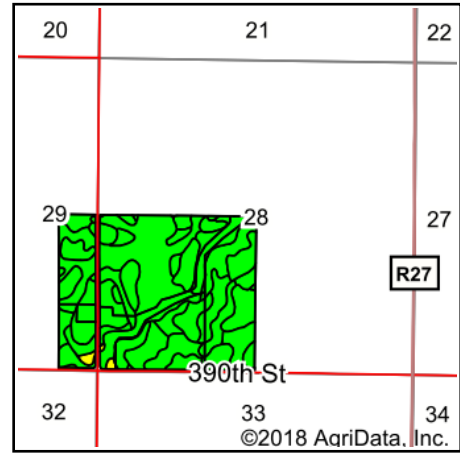

State: **Iowa**
 County: **Hamilton**
 Location: **28-86N-26W**
 Township: **Marion**
 Acres: **193.34**
 Date: **6/4/2018**

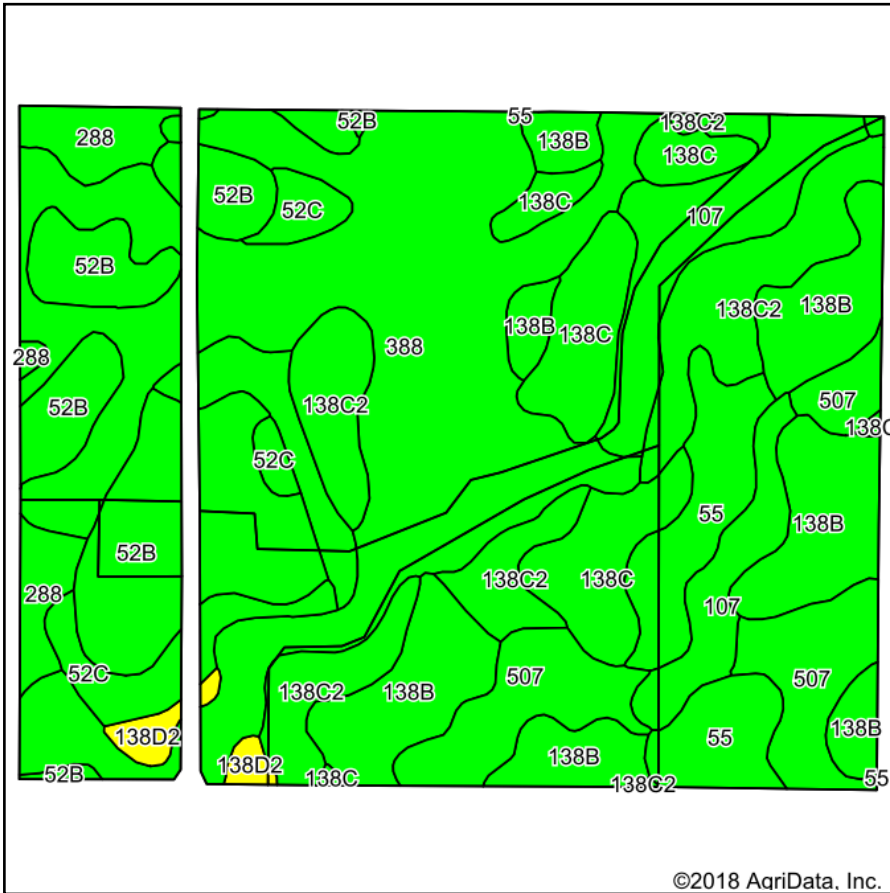

Soils data provided by USDA and NRCS.

©2018 AgriData, Inc.

Area Symbol: IA079, Soil Area Version: 21

Code	Soil Description	Acres	Percent of field	CSR2 Legend	Non-Irr Class *c	*i Corn	*i Soybeans	CSR2**	CSR
388	Kossuth silty clay loam, 0 to 2 percent slopes	54.53	28.2%		llw	224	65	86	79
138B	Clarion loam, 2 to 6 percent slopes	25.06	13.0%		lle	225.6	65.4	89	82
52B	Bode clay loam, 2 to 6 percent slopes	22.94	11.9%		lle	225.6	65.4	91	80
138C2	Clarion loam, 6 to 10 percent slopes, moderately eroded	19.74	10.2%		llle	204.8	59.4	83	65
107	Webster clay loam, 0 to 2 percent slopes	14.08	7.3%		llw	224	65	86	85
138C	Clarion loam, 6 to 10 percent slopes	14.08	7.3%		llle	209.6	60.8	84	67
507	Canisteo clay loam, 0 to 2 percent slopes	14.06	7.3%		llw	224	65	84	80
55	Nicollet clay loam, 1 to 3 percent slopes	10.72	5.5%		lw	233.6	67.7	89	90
288	Ottosen clay loam, 1 to 3 percent slopes	9.38	4.9%		lw	233.6	67.7	91	86
52C	Bode clay loam, 5 to 9 percent slopes	7.00	3.6%		llle	209.6	60.8	86	65
138D2	Clarion loam, 9 to 14 percent slopes, moderately eroded	1.75	0.9%		llle	164.8	47.8	57	55
Weighted Average						221.3	64.2	86.5	77.9

**IA has updated the CSR values for each county to CSR2.

*i Yield data provided by the ISPAID Database version 8.1.1 developed by IA State University.

*c: Using Capabilities Class Dominant Condition Aggregation Method

Soils data provided by USDA and NRCS.